

Putnam County, NY

Property

Municipality: Kent

SWIS: 372200

Tax ID: 31.-1-26

Owners

[County of Putnam](#)
48 Gleneida Ave
Carmel, NY 10512

Property Data

Property Address	71 Richardsville Rd Kent NY 0
Status	Active
Roll Section	Taxable
Property Class	210 - 1 Family Res
Ownership Code	
In Ag District	False
Zoning	R40 - Res. 40,000 Min
Neighborhood	500 Outside
School District	Carmel Central
Former Tax ID	13500000010350000000 00200000000000000461 135-1-35
Total Acreage/Size	4.85
Deed Book	2394
Deed Page	289
Grid East	695579
Grid North	955774

[View Map](#)

Sales

Additional Parcels Involved in Sale

Residential Buildings

Improvements

Valuation

Special Districts

Exemptions

Land

Tax Summary

Taxable Values

GIS Map

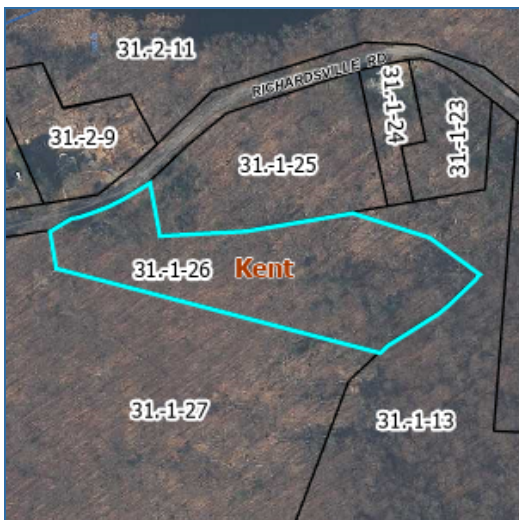

No data available for the following modules: Historic Deed, Inventory, Commercial Buildings, Utilities, Site Uses, Comparable Search (Com), Photos.

The Putnam County, NY Geographic Information Web Server provides online access to geographic and assessment record info currently maintained by Putnam County, NY for individual parcels of property. The maps and data are for illustration purposes and may not be suitable for site-specific decision making. Information found within should not be used for making financial or other commitments. The data contained herein is a matter of public record.
| [User Privacy Policy](#) | [GDPR Privacy Notice](#)
[Last Data Upload: 7/25/2025, 2:00:54 AM](#)

Contact Us

