

# Putnam County, NY

## Property

**Municipality:** Kent

**SWIS:** 372200

**Tax ID:** 42.11-1-16

## Owners

[County of Putnam](#)  
48 Gleneida Ave  
Carmel, NY 10512

## Property Data

Property Address	Golf Ridge Rd Kent NY 0
Status	Active
Roll Section	Taxable
Property Class	311 - Res vac land
Ownership Code	
In Ag District	False
Zoning	R80 - Res. 80,000 Min
Neighborhood	600 Sag/Sedge/Gypsy
School District	Carmel Central
Former Tax ID	13700000020150000000 002600000000000000420 137-2-15
Total Acreage/Size	5.2
Deed Book	2394
Deed Page	289
Grid East	698424
Grid North	948188

[View Map](#)

## Sales

### Additional Parcels Involved in Sale

### Residential Buildings

### Valuation

### Special Districts

### Exemptions

### Land

### Tax Summary

### Taxable Values

### GIS Map

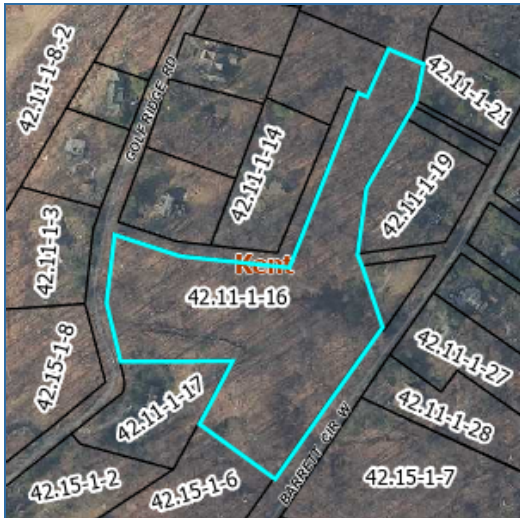

No data available for the following modules: Historic Deed, Inventory, Commercial Buildings, Utilities, Site Uses, Improvements, Comparable Search (Com), Photos.

The Putnam County, NY Geographic Information Web Server provides online access to geographic and assessment record info currently maintained by Putnam County, NY for individual parcels of property. The maps and data are for illustration purposes and may not be suitable for site-specific decision making. Information found within should not be used for making financial or other commitments. The data contained herein is a matter of public record. | [User Privacy Policy](#) | [GDPR Privacy Notice](#)  
[Last Data Upload: 7/25/2025, 2:00:54 AM](#)

[Contact Us](#)

